

Vorderansicht

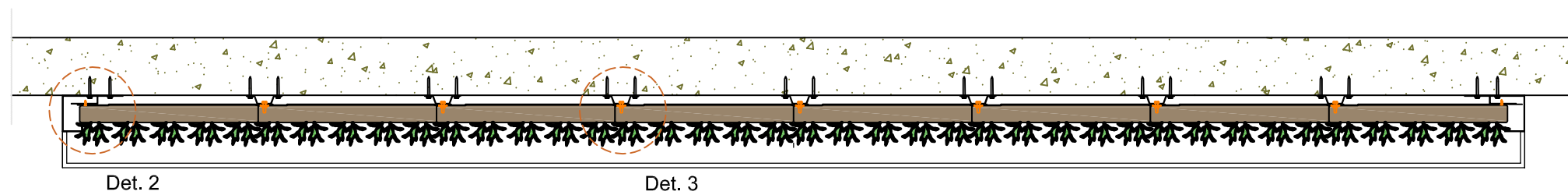

Querschnitt B-B

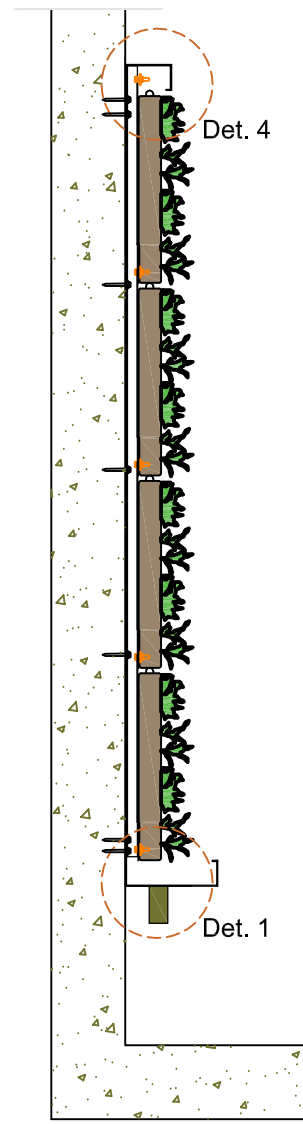

Querschnitt A-A

Cradle to Cradle
zertifiziert



Max. gesättigtes
Gewicht



Webbasiertes
Bewässerungssystem



Garantie Flexipanel

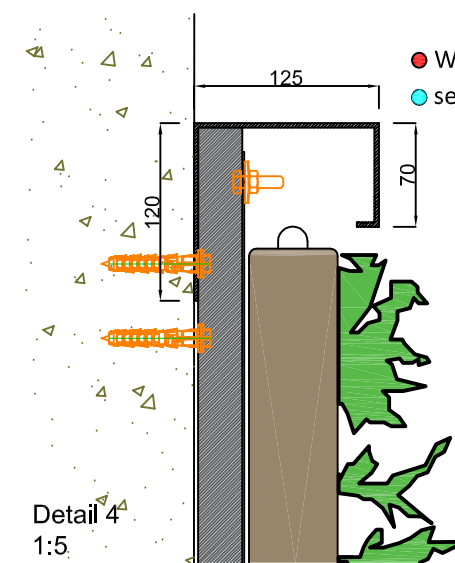
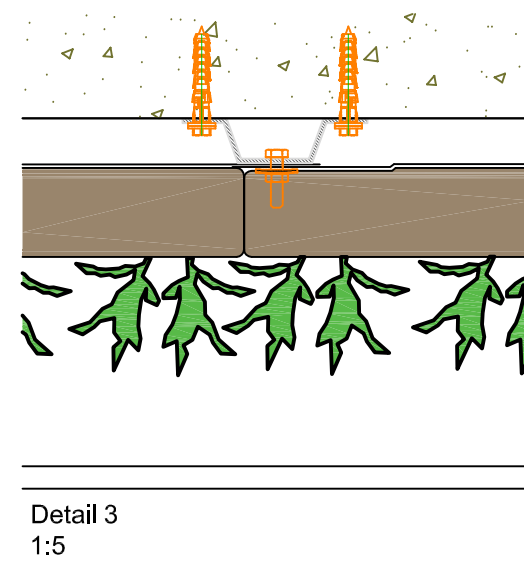
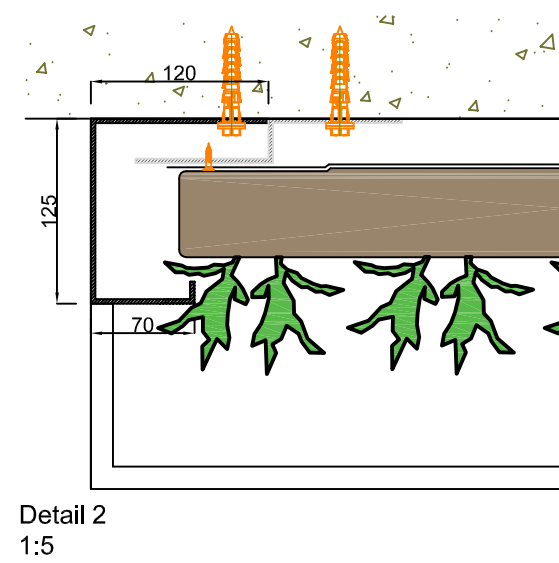
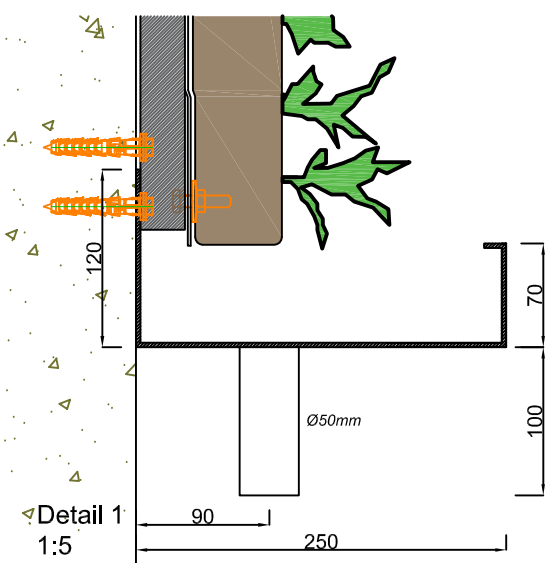

- Wasserleitung 3/4" Innengewinde DN15-32 Pex/Al/Pex
- sensorkabel Feuchtesensor Typ CY 2 x 0,5-1,0mm²

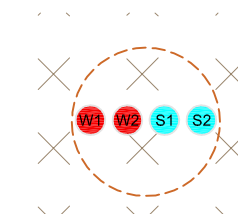

Detail A
1:5

Beschreibung
SemperGreenwall
Indoor

Maßstab
1:20 / 1:5

Format
A3

Datum
25.01.2021

Zeichnung Nr.
SGWI-S01



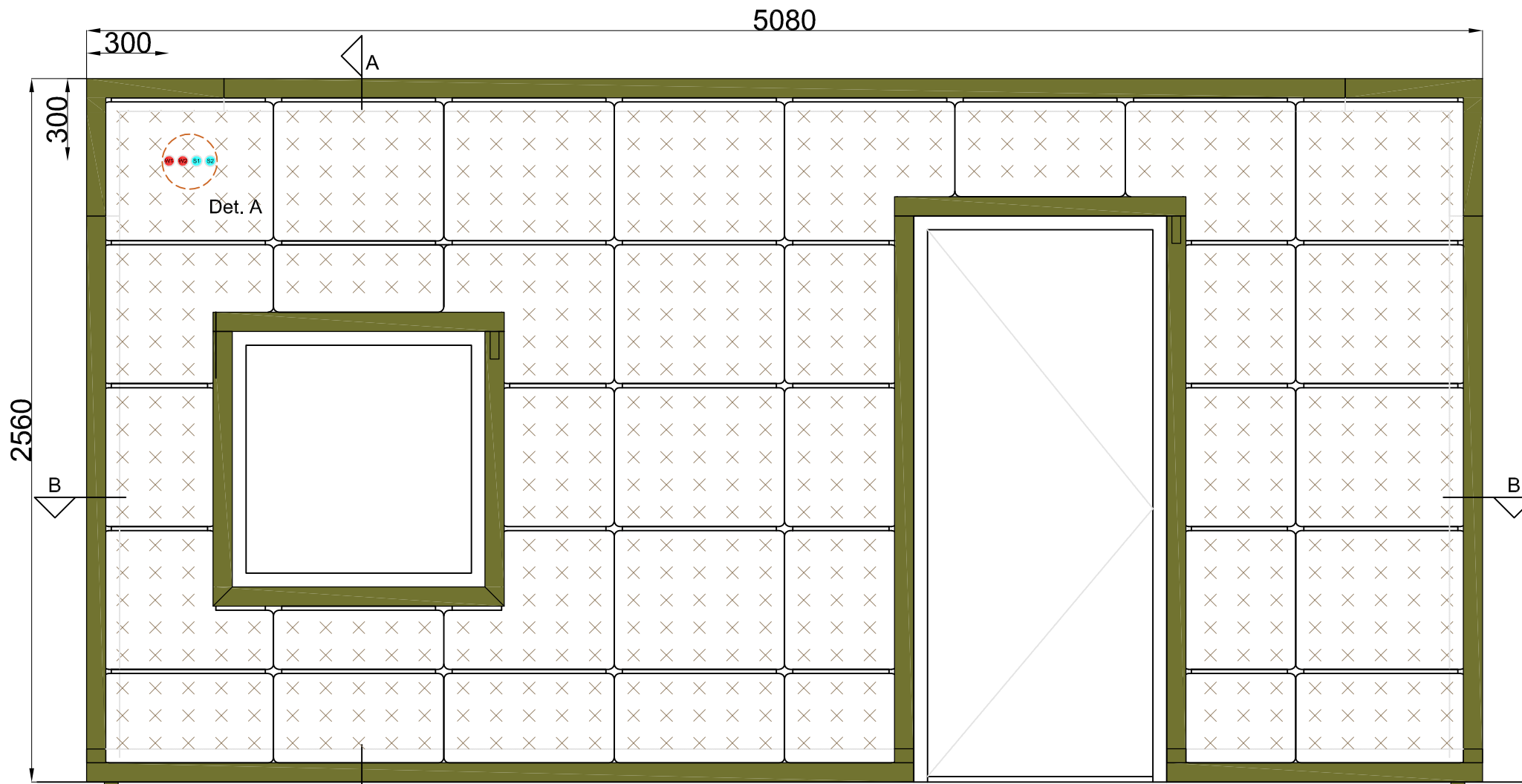

Vorderansicht

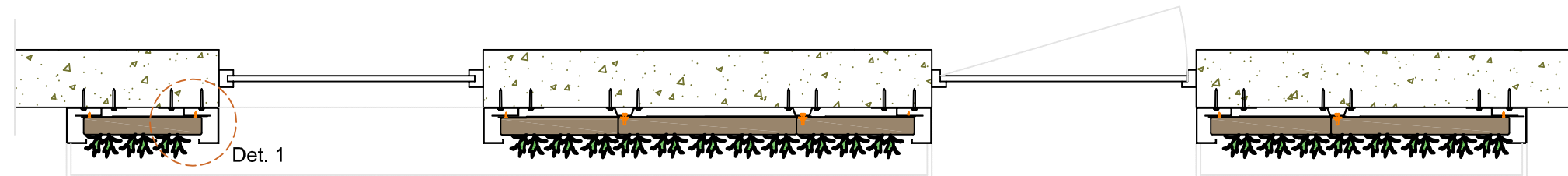

Querschnitt

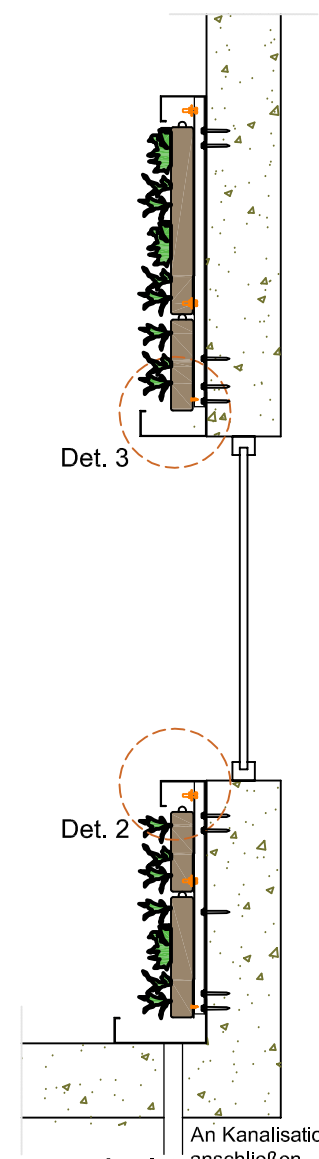
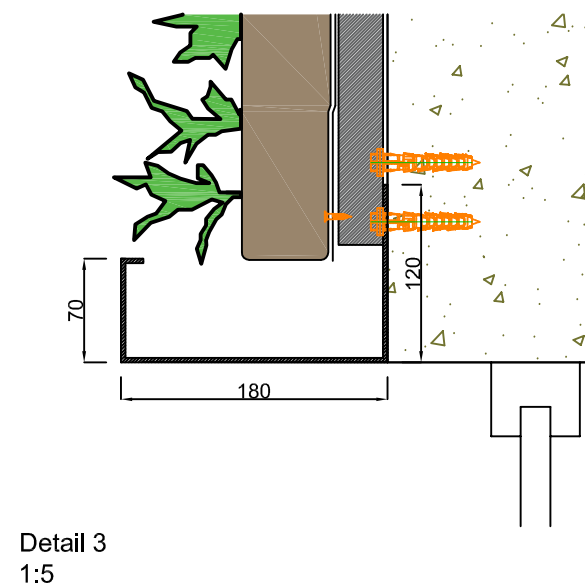
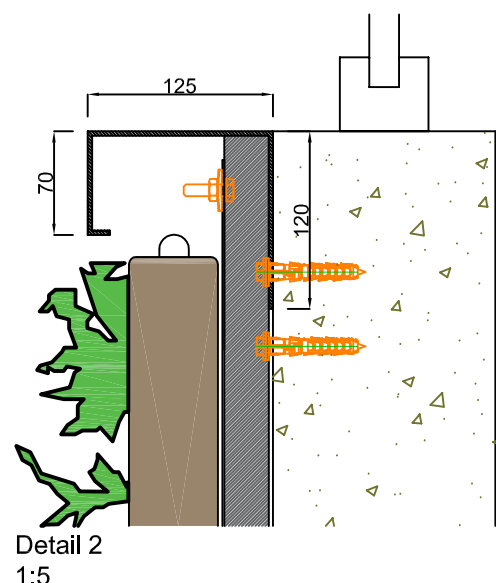
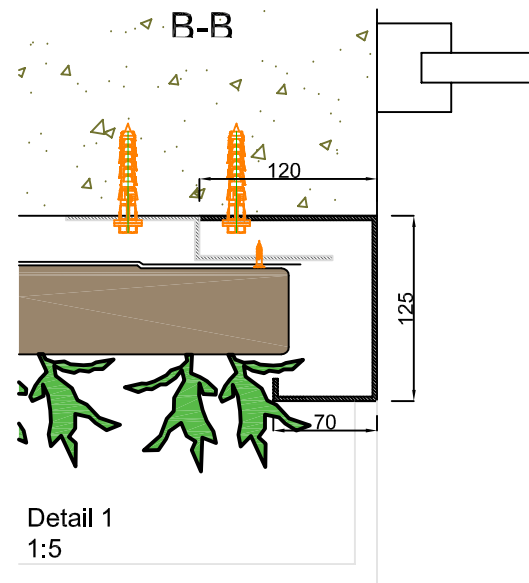

Querschnitt A-A

Cradle to Cradle zertifiziert



Max. gesättigtes Gewicht



Webbasiertes Bewässerungssystem



Garantie Flexipanel

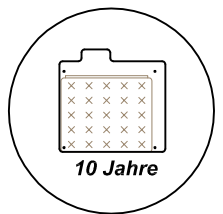

- Wasserleitung 3/4" Innengewinde DN15-32 Pex/Al/Pex
- sensor kabel Feuchtesensor Typ CY 2 x 0,5-1,0mm²

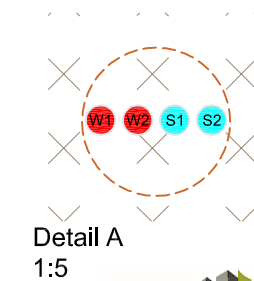

Detail A 1:5



www.sempergreenwall.com

Beschreibung
SemperGreenwall
Indoor Fenster- / Türdetails

Maßstab
1:20 / 1:5

Format
A3

Datum
25.01.2021

Zeichnung Nr.
SGWI-S02

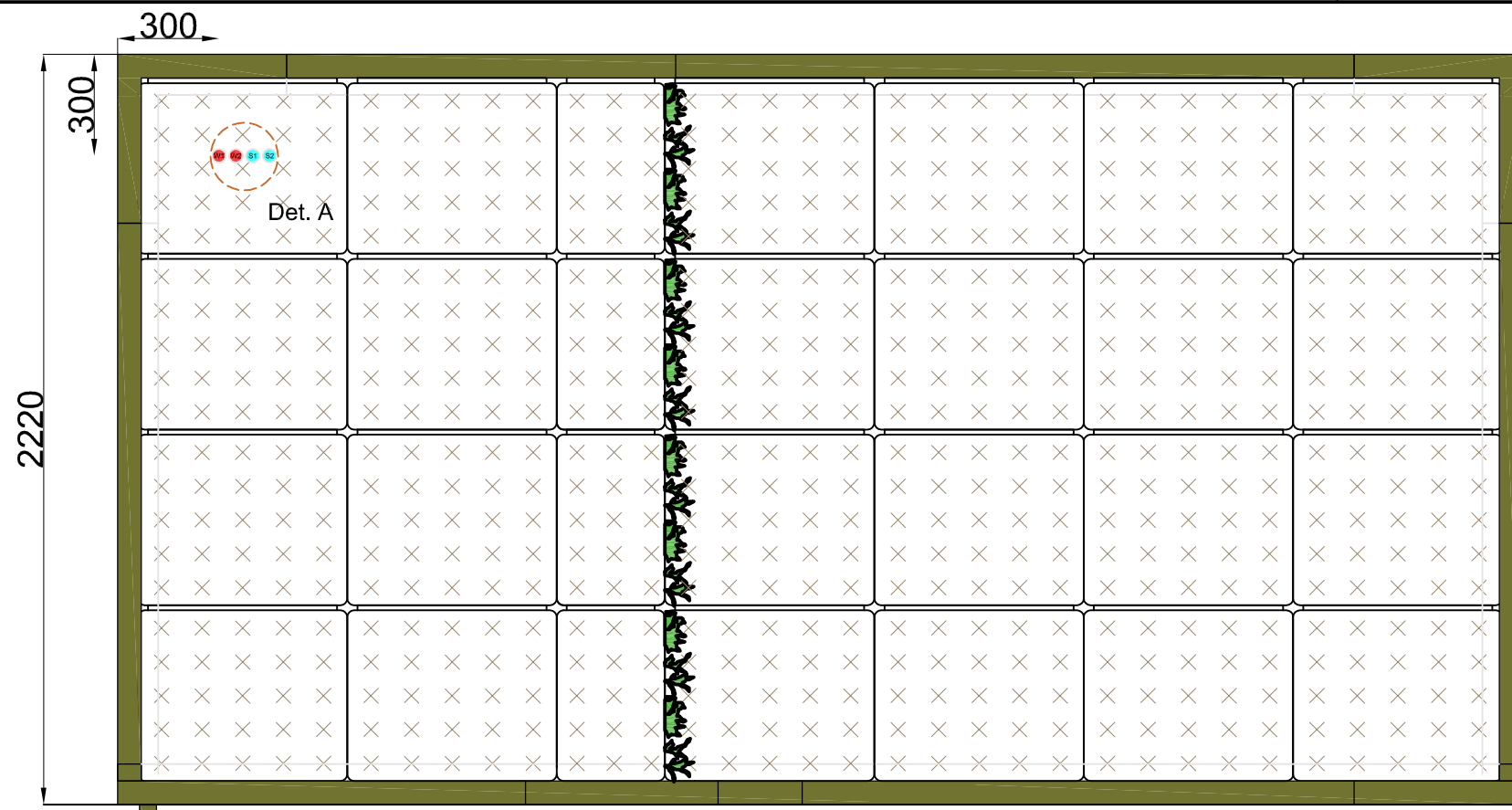

Ansicht A.

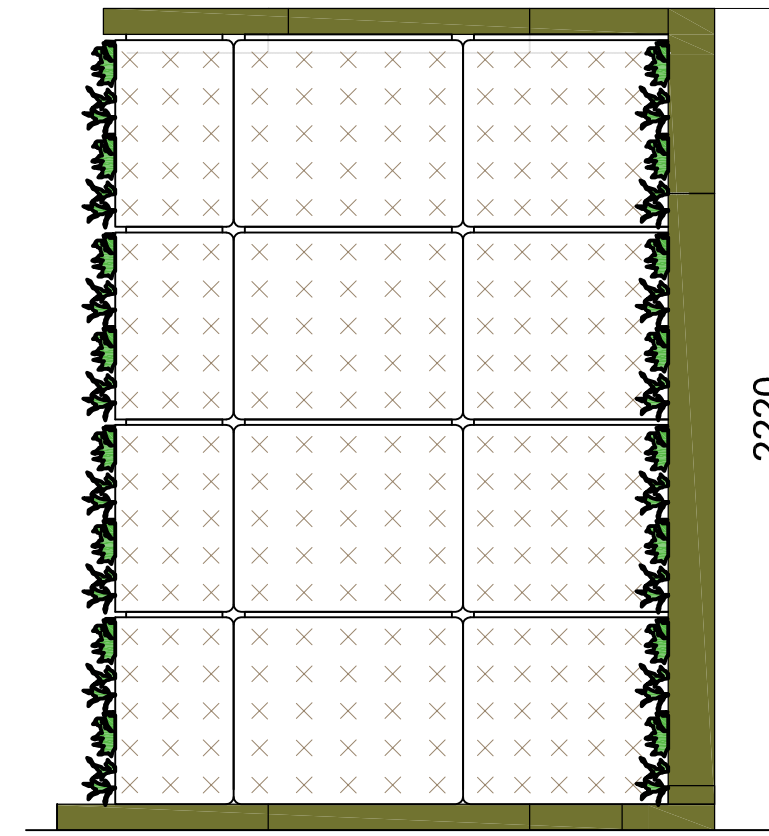

Ansicht B.

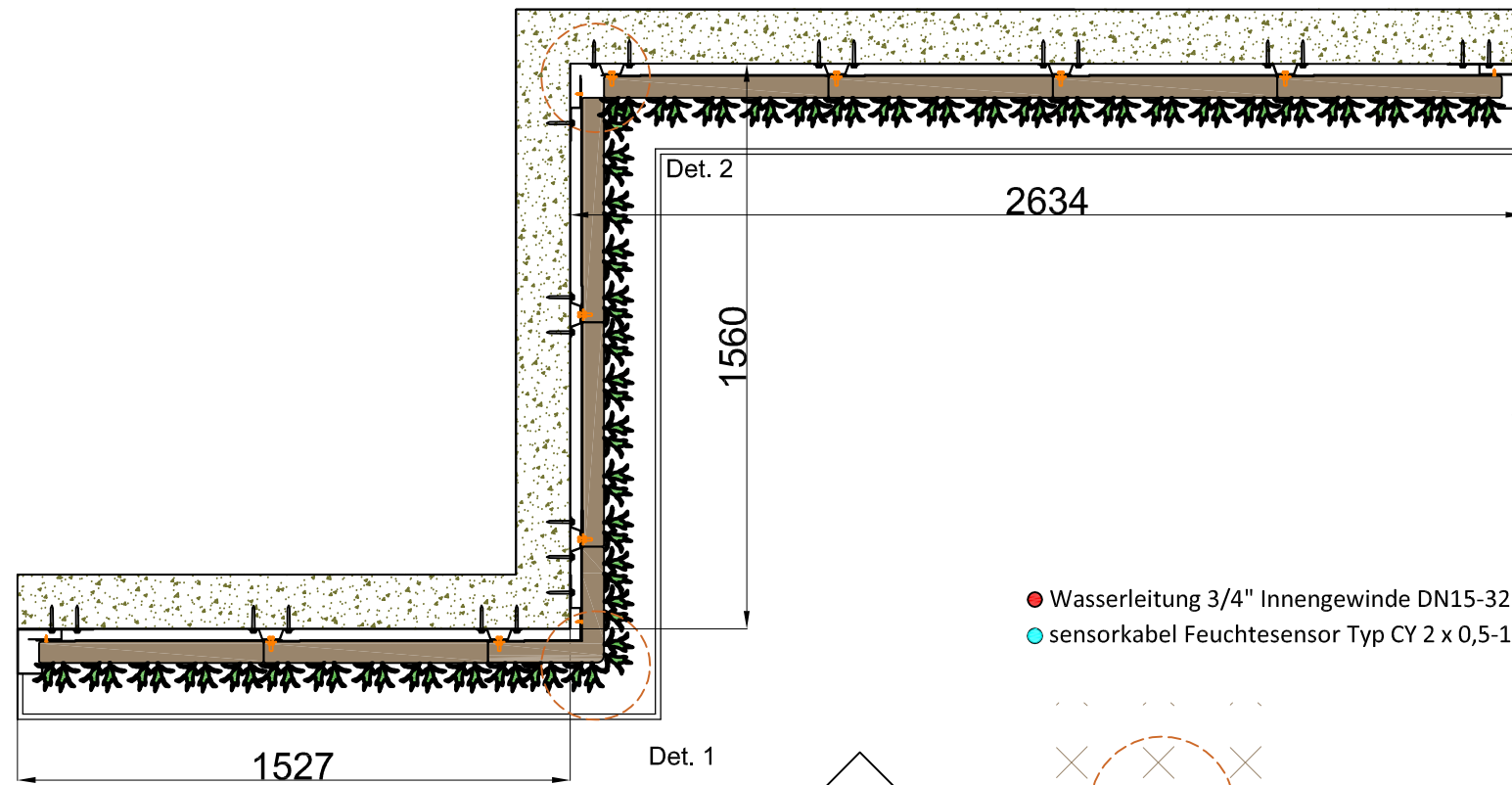

A

Detail A
1:8

B

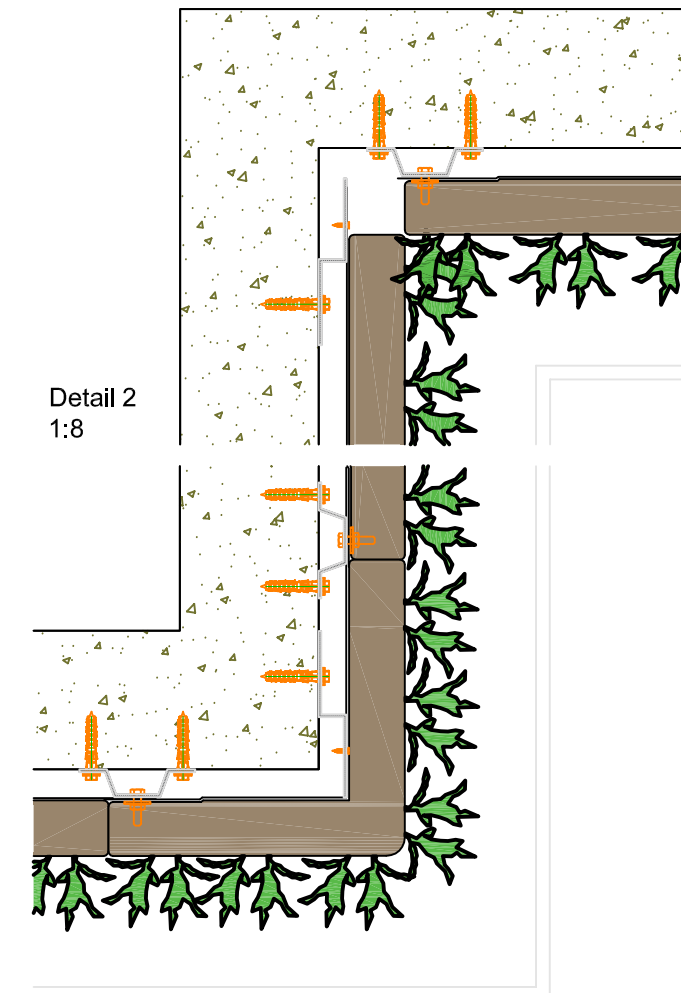

Detail 2
1:8

Detail 1
1:8

Cradle to Cradle
zertifiziert



Max. gesättigtes
Gewicht



Webbasiertes
Bewässerungssystem



Garantie Flexipanel

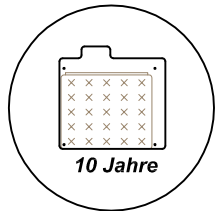

Beschreibung
SemperGreenwall
Indoor Eckdetails

Maßstab
1:20 / 1:8

Format
A3

Datum
25.01.2021

Zeichnung Nr.
SGWI-S03

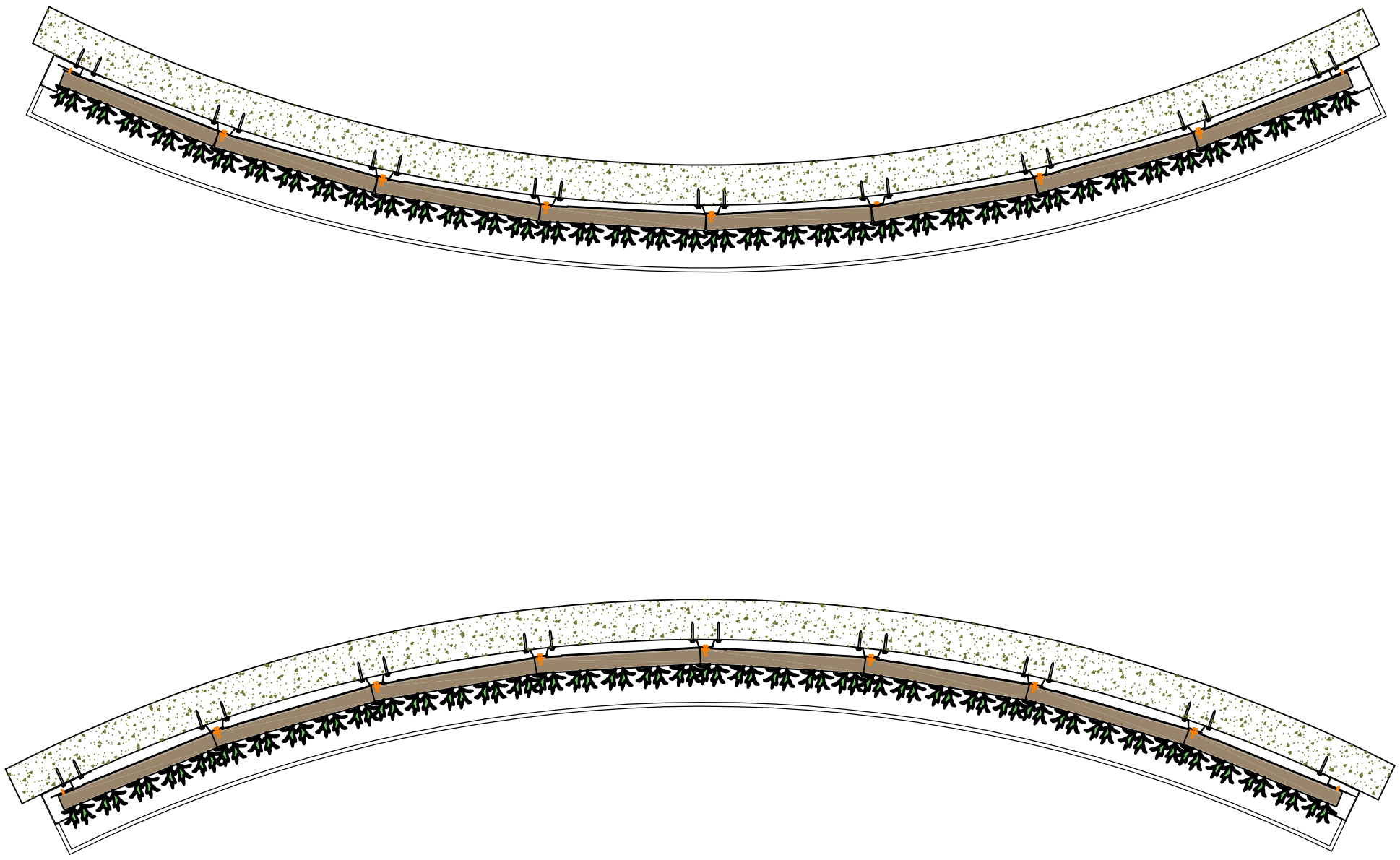

Cradle to Cradle
zertifiziert

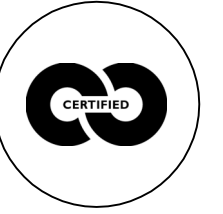

Max. gesättigtes
Gewicht

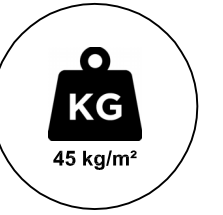

Webbasiertes
Bewässerungssystem



Garantie Flexipanel

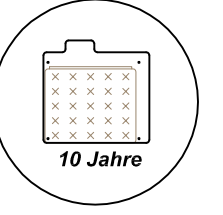

Beschreibung
SemperGreenwall
Indoor gebogene wand

Maßstab
1:20

Format
A3

Datum
25.01.2021

Zeichnung Nr.
SGWI-S04